

CABLE ASSEMBLY  
(ONE LEG SHOWN)

3/8" SIZE CS OR 304 SS  
SPLIT CHAIN LINK  
OR 1/4" TYPE 316 SS  
ROD PER DETAIL 1

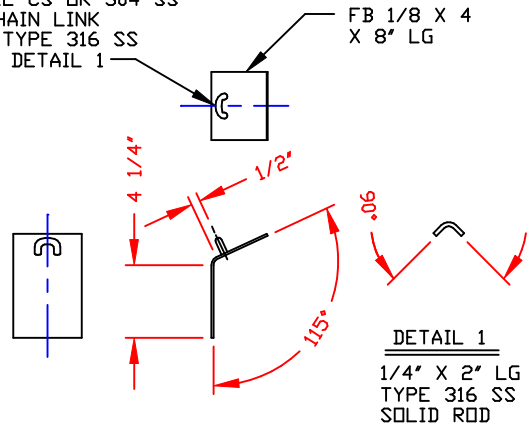

EDGE SOFTENER  
FOR NON-INSULATED TANKS  
SIZE: ES

NOTE:

1. BREAK RADII APPROX 3/8 INCHES
2. BREAK ALL SHARP CORNERS



NOTE:

1. THIS IS A COMPUTER GENERATED DRAWING. DO NOT REVISE BY HAND.

DWG TITLE		CABLE ASSEMBLY FOR VERTICAL TANK RESTRAINT SYSTEMS		
SCALE: 1 1/2"=1'-0"		Central Region P.O. Box 4190 71210 2901 Old Sherlington Rd. Monroe, LA 70203 CEN 243-7965 FAX CEN 243-8795	DR: J. BRANTLEY	CK: MB WILKERSON
DATE: 5/18/01		SHEET 1 OF 1	COMPUTER FILE RESTSYSC	REV B

REV "A" REMOVED INSULATED EDGE SOFTENERS BY:JB 10-14-02 CK:MBW  
REV "B" REMOVED TURNBUCKLES BY:JB 10-14-02 CK:MBW